

Summary Sheet

Date	8/05/13
Grid Reference	SE 403 086
Site Area	16.9ha
Surveyor	Chris Doar and Oliver Pescott, Wildscapes

Site Name	Symphony Site
Site Ref Number	C2

1 ASSESSMENT

Biodiversity interest (record presence by a cross as appropriate)

Habitat	Present	Notes & photo refs
Woodland	X	Young strip of plantation woodland
Scrub	X	Along stream
Scattered trees	X	Along stream
Species poor or defunct hedgerows		
Species rich hedgerows		
Amenity or improved grassland		
Semi-improved grassland	X	C2.2
Unimproved grassland		
Marshy grassland		
Tall ruderals		
Dwarf shrub heath		
Lichen/bryophyte heath		
Reedbed		
Swamp	X	
Standing water (ponds)		
Flowing watercourses	X	C2.1
Arable / cultivated farmland		
Other: Bare ground	X	

Species	Present (seen)	Quality of habitat		
		Low	Mod	High
Plants	X			
Invertebrates	X			
Amphibians			X	
Reptiles		X		
Birds	X			X
Mammals	X		X	
Fish			X	
Other				

Influences on external features

On watercourse	Yes. A stream runs along the site's north and eastern boundary, with a large pond immediately adjacent to the site.
On wildlife corridor	Partially – a dismantled railway line runs along the western edge of the site leading into C1.
Would lead to habitat isolation	Yes. Development of this site, without adequate mitigation, would risk isolating the adjacent pond from the surrounding countryside.
Proximity/linkage to SSSI/LNR	None
Other	

2 RECOMMENDATION

	Mitigation measures / design considerations	Score
a) Development of the site would have minimal detrimental local ecological impact.		
b) Development of the site would result in some adverse local ecological impact but there is scope for mitigation.	<p>It is strongly recommended that any future development of this site includes the provision of an ecological buffer zone along its northern and eastern boundaries to protect the stream and wetland habitats present in this area. This buffer zone would also help to strengthen the connectivity of the adjacent pond with the countryside to the west. See Figure 2.</p> <p>It is also recommended that a strip of native shrubs and trees is planted along the western boundary. This will allow the corridor formed by the adjacent dismantled railway line to continue.</p> <p>Additionally, as Skylark are breeding on site, the timing of development is critical, and should begin outside of the breeding season to prevent disturbance to breeding birds.</p>	3
c) Development of the site would result in detrimental ecological impacts.		

3 PHOTOGRAPHIC DETAILS

Photograph locations are recorded on the site map.

Photo Ref	Caption
C2.1	Stream on site's eastern boundary.
C2.2	View over grassland

4 FURTHER INFORMATION

Brief Site Description

This large site comprises areas of bare ground and species-poor semi-improved grassland within an industrial complex. A large pond is present immediately adjacent to the site's north-eastern corner, and a number of watercourses (stream and wet ditches) form its northern and eastern boundary.

In common with many such industrial sites, the survey area has been flattened and compacted and seeded with a wildflower mix, in preparation for future development. The sward across these areas is sparse, with impeded drainage leading to the formation of seasonally wet areas. Large areas of bare ground are also present. A stream and wet ditches are found on the site's northern and eastern boundaries. These support a range of wetland species. Young strips of plantation woodland are also present.

As well as plant species, Brown Hare and breeding pairs of Skylark were recorded on site.

Additional comments / information

Breeding Skylark are present on site. This species is Red Listed, being of great conservation concern. It should also be noted that disturbing breeding birds is an offense under the Wildlife and Countryside Act 1981. Any future development should be timed to ensure that no breeding skylark will be disturbed.

A search of local records revealed that water voles have been recorded on a small stream in Grimethorpe that links to the stream in site C2. It is recommended that the stream in C2 is assessed for water voles before any development takes place.

Figure 1 shows the Phase 1 Habitat map for the site.
Figure 2 shows the areas with significant ecological value.

Ferrymore Area

Sub-site C2

Site Area: 16.9 ha

OS Grid Ref: SE 403 086

Date Surveyed: 8/05/13

Surveyor: Chris Doar and Oliver Pescott

Site Description

This large site comprises areas of bare ground and species-poor semi improved grassland within an industrial complex. The site is bounded by the A6195 to the east, and Ferrymore Landfill site to the west. A large pond is present immediately adjacent to the site's north-eastern corner, and a number of watercourses (stream and wet ditches) form its northern and eastern boundary.

In common with many such industrial sites, the survey area has been flattened and compacted and seeded with a wildflower mix, in preparation for future development. The sward across these areas is sparse, with impeded drainage leading to the formation of seasonally wet areas. The species-poor semi-improved grasslands are dominated by grasses such as Creeping Bent (*Agrostis stolonifera*), Velvet Bent (*Agrostis canina*) and Yorkshire Fog (*Holcus lanatus*). White clover (*Trifolium repens*), Bird's-foot Trefoil (*Lotus corniculatus*), Creeping Buttercup (*Ranunculus repens*) and Ribwort plantain (*Plantago lanceolata*) are frequent in the sward, whilst ruderal species such as Dandelion (*Taraxacum* agg.), Colt's-foot (*Tussilago farfara*) and Teasel (*Dipsacus fullonum*) are common.

Where the earth has been bunded on the site periphery, the same semi-improved, neutral grassland was recorded but here the sward was much lusher, with Cocksfoot (*Dactylis glomerata*) abundant.

The stream and wet ditches found on the site's northern and eastern boundaries support a range of wetland species. Common reed (*Phragmites australis*), Bulrush (*Typha latifolia*) and Reed Canary Grass (*Phalaris arundinacea*) are all present in places along the channel. Great Willowherb (*Epilobium hirsutum*) and Common Nettle (*Urtica dioica*) dominate the bank in open areas, whilst in others a shrub willow (*Salix* sp.), Hawthorn (*Crataegus monogyna*) and Crack Willow (*S. fragilis*) are dominant, the Crack Willow forming a closed canopy over the stream.

Two narrow strips of planted tree and shrub species were present on site. These contained a broad mix of native species, including Silver Birch (*Betula pendula*), Willow (*Salix* sp.), Hawthorn and Pine (*Pinus* sp.) and appeared to have been planted within the past 5 years.

As well as plant species, two animal species of note were recorded on site. The first were at least 2 pairs of Skylark (*Alauda arvensis*), who were nesting on the western half of the site (west of Ferrymore Way). Additionally, a drove of Brown Hare (*Lepus europeaus*), numbering 9 individuals were noted feeding and boxing adjacent to the site's western boundary.



Photo C2.1 Stream on site's eastern boundary.



Photo C2.2 View over grassland.

Species List for C2

DAFOR Scale

D=dominant, A=abundant, F=frequent, O=occasional, R=rare, L=locally

Grassland

Trees and Shrubs

Rose	<i>Rosa</i> sp.	R
------	-----------------	---

Herbs

Yarrow	<i>Achillea millefolium</i>	O
Greater Burdock	<i>Arctium lappa</i>	R
Winter-cress	<i>Barbarea vulgaris</i>	R
Wavy Bittercress	<i>Cardamine flexuosa</i>	R
Chicory	<i>Cichorium intybus</i>	R
Creeping Thistle	<i>Cirsium arvense</i>	O
Spear Thistle	<i>Cirsium vulgare</i>	O
Teasel	<i>Dipsacus fullonum</i>	LF
Broad-leaved Willowherb	<i>Epilobium montanum</i>	O
Cut-leaved Cranesbill	<i>Geranium dissectum</i>	R
Oxeye Daisy	<i>Leucanthemum vulgare</i>	R
Common Bird's-foot Trefoil	<i>Lotus corniculatus</i>	A
Black Medick	<i>Medicago lupulina</i>	O
Melilot	<i>Melilotus</i> sp.	R
Poppy	<i>Papaver</i> sp.	R
Ribwort Plantain	<i>Plantago lanceolata</i>	F
Creeping Buttercup	<i>Ranunculus repens</i>	A
Broad-leaved Dock	<i>Rumex obtusifolius</i>	O
Common Ragwort	<i>Senecio jacobaea</i>	O
Groundsel	<i>Senecio vulgaris</i>	R
Dandelion	<i>Taraxacum</i> agg.	F
Goat's-beard	<i>Tragopodium pratensis</i>	R
Red Clover	<i>Trifolium pratense</i>	O
White Clover	<i>Trifolium repens</i>	F
Coltsfoot	<i>Tussilago farfara</i>	F
Common Nettle	<i>Urtica dioica</i>	R
Germander Speedwell	<i>Veronica chamaedrys</i>	R
Vetch	<i>Vicia</i> sp.	O

Grasses, sedges and rushes

Velvet Bent	<i>Agrostis canina</i>	LD
Creeping Bent	<i>Agrostis stolonifera</i>	D
Cock's-foot	<i>Dactylis glomerata</i>	LA
Tufted Hair-grass	<i>Deschampsia cespitosa</i>	O
Red Fescue	<i>Festuca rubra</i>	LF
Yorkshire Fog	<i>Holcus lanatus</i>	A
Hard Rush	<i>Juncus inflexus</i>	O
Perennial Rye-grass	<i>Lolium perenne</i>	LA
Reed Canary-grass	<i>Phalaris arundinacea</i>	R
Annual Meadow-grass	<i>Poa annua</i>	F
Smooth Meadow-grass	<i>Poa pratensis</i>	O

Stream and ditches

Trees and Shrubs

Birch	<i>Betula</i> sp.	A
Hawthorn	<i>Crataegus monogyna</i>	LD
Bramble	<i>Rubus fruticosus</i> agg.	LD
Crack Willow	<i>Salix fragilis</i>	LD
Willow	<i>Salix</i> sp.	F
Elder	<i>Sambucus nigra</i>	R

Herbs

Rosebay Willowherb	<i>Chamerion angustifolium</i>	LF
Hemlock	<i>Conium maculatum</i>	R
Teasel	<i>Dipsacus fullonum</i>	O
Great Willowherb	<i>Epilobium hirsutum</i>	LD
Hogweed	<i>Heracleum sphondylium</i>	O
Perforate St John's-wort	<i>Hypericum perforatum</i>	R
Broad-leaved Dock	<i>Rumex obtusifolius</i>	O
Coltsfoot	<i>Tussilago farfara</i>	O

Grasses, sedges and rushes

Cock's-foot	<i>Dactylis glomerata</i>	A
Tufted Hair-grass	<i>Deschampsia cespitosa</i>	O
Yorkshire Fog	<i>Holcus lanatus</i>	A
Compact Rush	<i>Juncus conglomeratus</i>	O
Hard Rush	<i>Juncus inflexus</i>	O
Reed Canary-grass	<i>Phalaris arundinacea</i>	LD
Common Reed	<i>Phragmites australis</i>	LF
Bulrush	<i>Typha latifolia</i>	LA

Woodland Planting

Trees and Shrubs

Field Maple	<i>Acer campestre</i>	O
Alder	<i>Alnus glutinosa</i>	F
Silver Birch	<i>Betula pendula</i>	F
Hazel	<i>Corylus avellana</i>	O
Hawthorn	<i>Crataegus monogyna</i>	F
Broom	<i>Cytisus scoparius</i>	O
Scots Pine	<i>Pinus sylvestris</i>	F
Blackthorn	<i>Prunus spinosa</i>	F
Dog Rose	<i>Rosa canina</i>	F
Willow	<i>Salix</i> sp.	F
Gorse	<i>Ulex europaeus</i>	O

Figure 1. Phase 1 Habitat Map: April 2013

Site C2

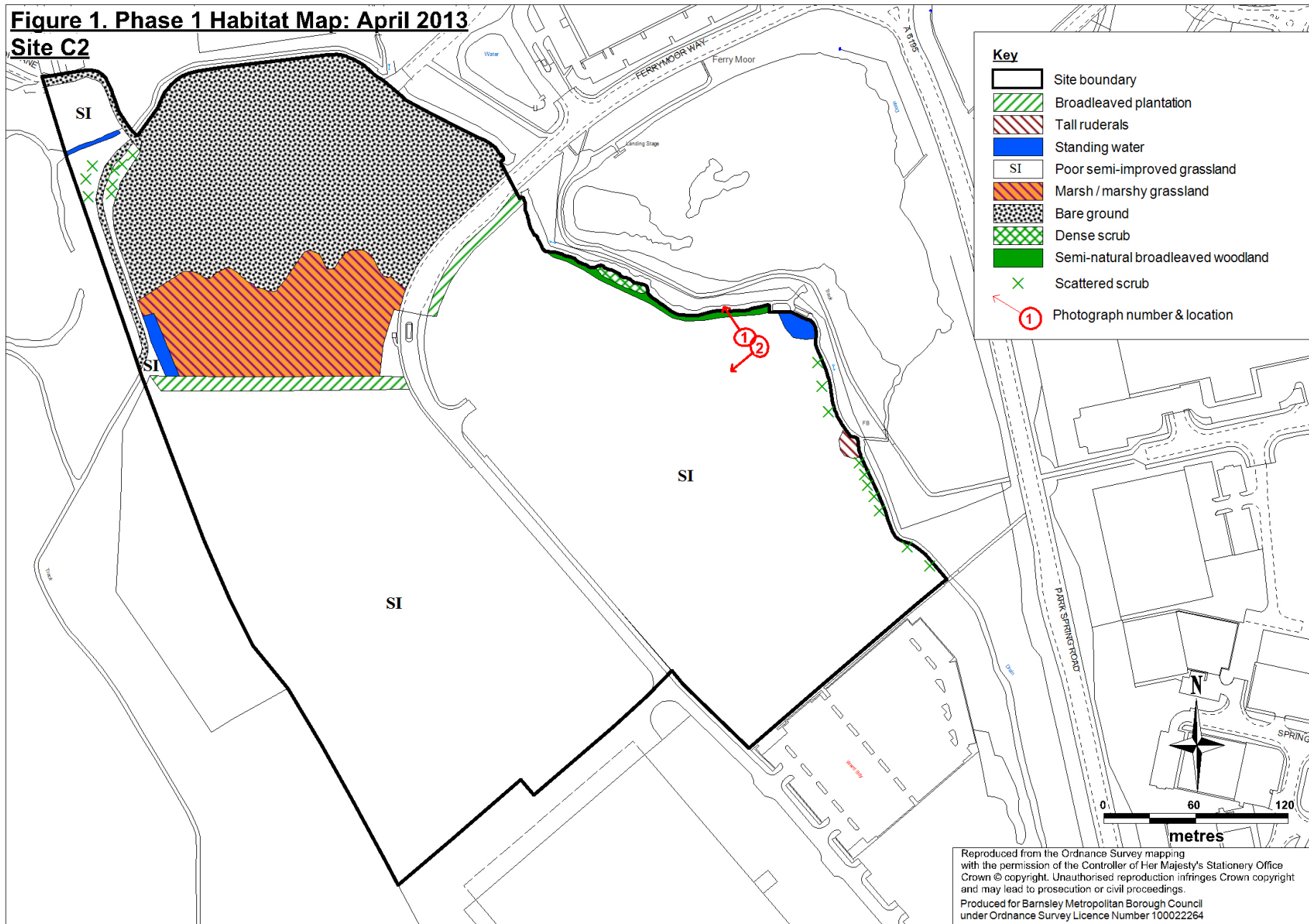
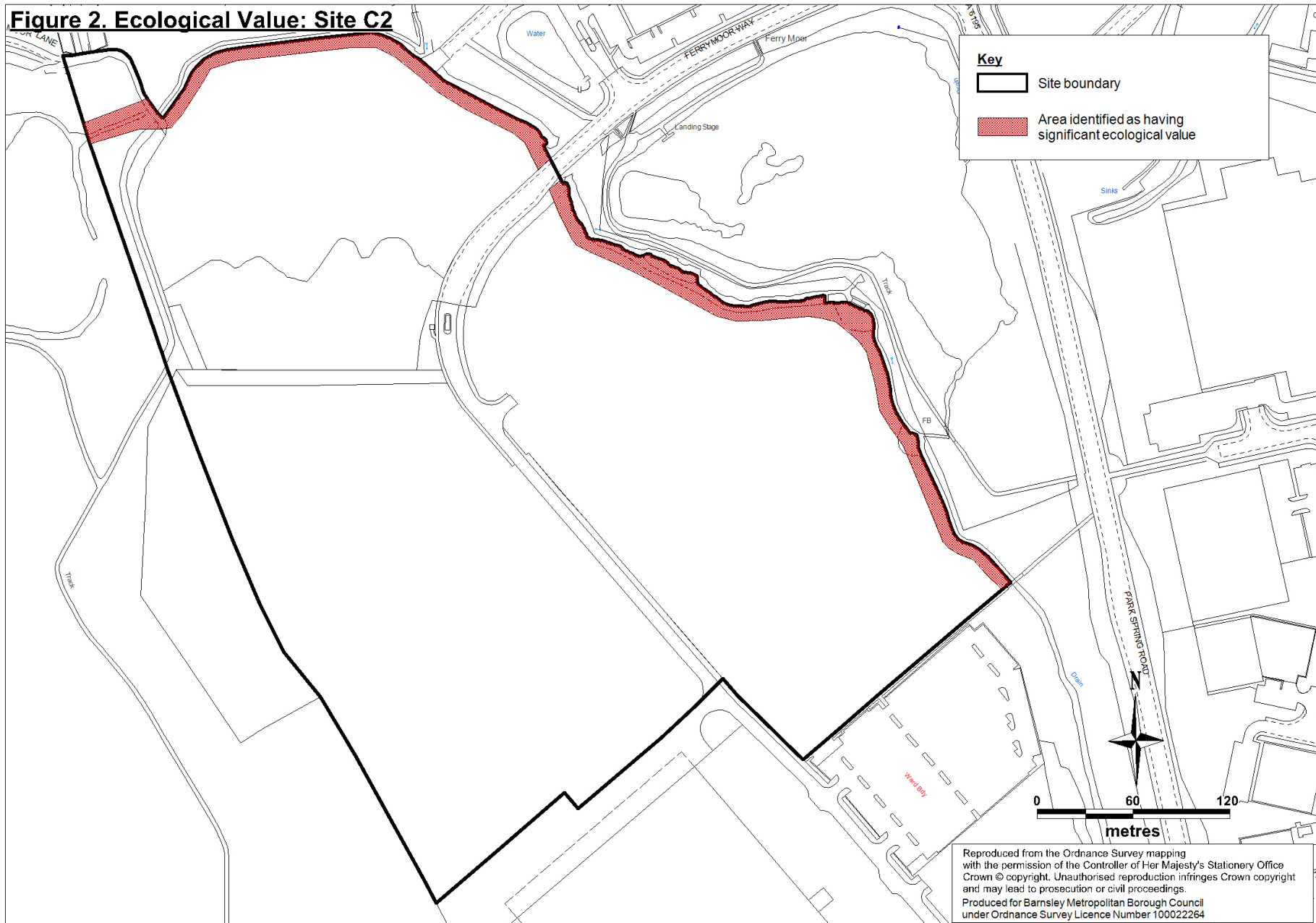

Figure 2. Ecological Value: Site C2



Data Search – Local Records Centre

Notable species recorded within 1km of the site in the last 10 years (2003 – 2013)

A search for badger records has been carried out separately.

Group	Scientific Name	Common Name	Year	Location
amphibian	<i>Bufo bufo</i>	Common Toad	2007	Barrow Colliery Barnsley
amphibian	<i>Bufo bufo</i>	Common Toad	2008	Grimesthorpe pond 2
amphibian	<i>Bufo bufo</i>	Common Toad	2008	Grimesthorpe pond 5
amphibian	<i>Bufo bufo</i>	Common Toad	2010	Grimesthorpe pond 6
amphibian	<i>Bufo bufo</i>	Common Toad	2012	Edderthorpe Ings
amphibian	<i>Bufo bufo</i>	Common Toad	2012	'BARNSELEY MBC'
amphibian	<i>Rana temporaria</i>	Common Frog	2008	Grimesthorpe pond 5
amphibian	<i>Rana temporaria</i>	Common Frog	2010	Grimesthorpe pond 6
amphibian	<i>Rana temporaria</i>	Common Frog	2012	'BARNSELEY MBC'
amphibian	<i>Triturus vulgaris</i>	Smooth Newt	2007	Cudworth pond 2
amphibian	<i>Triturus vulgaris</i>	Smooth Newt	2007	Cudworth pond 1
amphibian	<i>Triturus vulgaris</i>	Smooth Newt	2008	Grimesthorpe pond 5
amphibian	<i>Triturus vulgaris</i>	Smooth Newt	2010	Grimesthorpe pond 6
bird	<i>Alauda arvensis</i>	Sky Lark	2004	Edderthorpe Ings
bird	<i>Alauda arvensis</i>	Skylark	2004	Short Wood fields
bird	<i>Alauda arvensis</i>	Skylark	2005	Barrow Colliery Barnsley
bird	<i>Alauda arvensis</i>	Skylark	2005	Broomhill Flash & Wombwell Ings LWS
bird	<i>Alauda arvensis</i>	Skylark	2007	Old Moor & Wath Ings LWS
bird	<i>Alauda arvensis</i>	Sky Lark	2007	Wilthorpe Marsh
bird	<i>Alauda arvensis</i>	Skylark	2009	Cudworth Common
bird	<i>Alauda arvensis</i>	Skylark	2009	Old Moor & Wath Ings LWS
bird	<i>Alauda arvensis</i>	Skylark	2011	Old Moor & Wath Ings LWS
bird	<i>Alauda arvensis</i>	Skylark	2011	Grimethorpe Colliery
bird	<i>Alauda arvensis</i>	Skylark	2013	Cudworth
bird	<i>Alauda arvensis</i>	Skylark	2013	Cudworth Common
bird	<i>Alauda arvensis</i>	Skylark	2013	Grimethorpe Barnsley
bird	<i>Alcedo atthis</i>	Kingfisher	2005	Broomhill Flash & Wombwell Ings LWS
bird	<i>Alcedo atthis</i>	Kingfisher	2007	River Dearne Valley wetlands, Dearne/Wombwell

bird	<i>Alcedo atthis</i>	Kingfisher	2007	Old Moor & Wath Ings LWS
bird	<i>Alcedo atthis</i>	Kingfisher	2009	Old Moor & Wath Ings LWS
bird	<i>Anas acuta</i>	Pintail	2007	Old Moor & Wath Ings LWS
bird	<i>Anas acuta</i>	Pintail	2009	Old Moor & Wath Ings LWS
bird	<i>Anas acuta</i>	Pintail	2011	Old Moor & Wath Ings LWS
bird	<i>Anas clypeata</i>	Northern Shoveler	2004	Edderthorpe Ings
bird	<i>Anas clypeata</i>	Shoveler	2007	Old Moor & Wath Ings LWS
bird	<i>Anas clypeata</i>	Shoveler	2007	Broomhill Flash
bird	<i>Anas clypeata</i>	Shoveler	2009	Old Moor & Wath Ings LWS
bird	<i>Anas clypeata</i>	Shoveler	2009	Edderthorpe Ings
bird	<i>Anas clypeata</i>	Shoveler	2011	Old Moor & Wath Ings LWS
bird	<i>Anas clypeata</i>	Shoveler	2011	Edderthorpe Ings
bird	<i>Anas clypeata</i>	Shoveler	2011	Edderthorpe Ings, between Little Houghton & Grimethorpe
bird	<i>Anas clypeata</i>	Shoveler	2012	Edderthorpe Ings
bird	<i>Anas querquedula</i>	Garganey	2005	Broomhill Flash & Wombwell Ings LWS
bird	<i>Anas querquedula</i>	Garganey	2007	Old Moor & Wath Ings LWS
bird	<i>Anas querquedula</i>	Garganey	2011	Edderthorpe Ings, between Little Houghton & Grimethorpe
bird	<i>Anas querquedula</i>	Garganey	2011	Old Moor & Wath Ings LWS
bird	<i>Anas strepera</i>	Gadwall	2004	Edderthorpe Ings
bird	<i>Anas strepera</i>	Gadwall	2006	Broomhill Flash
bird	<i>Anas strepera</i>	Gadwall	2007	Old Moor & Wath Ings LWS
bird	<i>Anas strepera</i>	Gadwall	2007	Broomhill Flash
bird	<i>Anas strepera</i>	Gadwall	2009	Old Moor & Wath Ings LWS
bird	<i>Anas strepera</i>	Gadwall	2009	Edderthorpe Ings
bird	<i>Anas strepera</i>	Gadwall	2010	Old Moor & Wath Ings LWS
bird	<i>Anas strepera</i>	Gadwall	2011	Old Moor & Wath Ings LWS
bird	<i>Anas strepera</i>	Gadwall	2011	Edderthorpe Ings, between Little Houghton & Grimethorpe
bird	<i>Anas strepera</i>	Gadwall	2013	Cudworth Common
bird	<i>Anser anser</i>	Greylag Goose	2007	Old Moor & Wath Ings LWS
bird	<i>Anser anser</i>	Greylag Goose	2009	Old Moor & Wath Ings LWS
bird	<i>Anser anser</i>	Greylag Goose	2009	Edderthorpe Ings
bird	<i>Anser anser</i>	Greylag Goose	2011	Old Moor & Wath Ings LWS

bird	<i>Anser anser</i>	Greylag Goose	2013	Grimethorpe Barnsley
bird	<i>Botaurus stellaris</i>	Bittern	2009	Old Moor & Wath Ings LWS
bird	<i>Bucephala clangula</i>	Goldeneye	2007	Old Moor & Wath Ings LWS
bird	<i>Bucephala clangula</i>	Goldeneye	2009	Old Moor & Wath Ings LWS
bird	<i>Bucephala clangula</i>	Goldeneye	2011	Old Moor & Wath Ings LWS
bird	<i>Calidris maritima</i>	Purple Sandpiper	2007	Old Moor & Wath Ings LWS
bird	<i>Charadrius dubius</i>	Little Ringed Plover	2005	Broomhill Flash & Wombwell Ings LWS
bird	<i>Charadrius dubius</i>	Little Ringed Plover	2007	Broomhill Flash
bird	<i>Charadrius dubius</i>	Little Ringed Plover	2007	Old Moor & Wath Ings LWS
bird	<i>Charadrius dubius</i>	Little Ringed Plover	2007	Wilthorpe Marsh
bird	<i>Charadrius dubius</i>	Little Ringed Plover	2007	Ferry Moor wader scrape
bird	<i>Charadrius dubius</i>	Little Ringed Plover	2009	Old Moor & Wath Ings LWS
bird	<i>Charadrius dubius</i>	Little Ringed Plover	2009	Cudworth Common
bird	<i>Charadrius dubius</i>	Little Ringed Plover	2010	Little Houghton Ings
bird	<i>Charadrius dubius</i>	Little Ringed Plover	2011	Old Moor & Wath Ings LWS
bird	<i>Charadrius dubius</i>	Little Ringed Plover	2011	Edderthorpe Ings, between Little Houghton & Grimethorpe
bird	<i>Charadrius dubius</i>	Little Ringed Plover	2012	Little Houghton Ings
bird	<i>Chlidonias niger</i>	Black Tern	2007	Old Moor & Wath Ings LWS
bird	<i>Chlidonias niger</i>	Black Tern	2011	Edderthorpe Ings, between Little Houghton & Grimethorpe
bird	<i>Coturnix coturnix</i>	Quail	2011	Edderthorpe Ings, between Little Houghton & Grimethorpe
bird	<i>Cygnus cygnus</i>	Whooper Swan	2007	Old Moor & Wath Ings LWS
bird	<i>Cygnus cygnus</i>	Whooper Swan	2009	Edderthorpe Ings, between Little Houghton & Grimethorpe
bird	<i>Cygnus cygnus</i>	Whooper Swan	2010	Old Moor & Wath Ings LWS
bird	<i>Cygnus cygnus</i>	Whooper Swan	2010	Edderthorpe Ings
bird	<i>Cygnus olor</i>	Mute Swan	2004	Edderthorpe Ings
bird	<i>Cygnus olor</i>	Mute Swan	2007	Old Moor & Wath Ings LWS
bird	<i>Cygnus olor</i>	Mute Swan	2007	Broomhill Flash
bird	<i>Cygnus olor</i>	Mute Swan	2009	Old Moor & Wath Ings LWS
bird	<i>Cygnus olor</i>	Mute Swan	2009	Edderthorpe Ings
bird	<i>Cygnus olor</i>	Mute Swan	2010	Old Moor & Wath Ings LWS
bird	<i>Cygnus olor</i>	Mute Swan	2011	Brampton
bird	<i>Cygnus olor</i>	Mute Swan	2011	Old Moor & Wath Ings LWS

bird	<i>Cygnus olor</i>	Mute Swan	2011	Edderthorpe Ings, between Little Houghton & Grimethorpe
bird	<i>Cygnus olor</i>	Mute Swan	2011	Wath Ings
bird	<i>Cygnus olor</i>	Mute Swan	2012	Edderthorpe Ings
bird	<i>Cygnus olor</i>	Mute Swan	2013	Grimethorpe Barnsley
bird	<i>Cygnus olor</i>	Mute Swan	2013	Cudworth Common
bird	<i>Falco peregrinus</i>	Peregrine	2007	Old Moor & Wath Ings LWS
bird	<i>Falco peregrinus</i>	Peregrine	2009	Old Moor & Wath Ings LWS
bird	<i>Falco subbuteo</i>	Hobby	2007	Old Moor & Wath Ings LWS
bird	<i>Falco subbuteo</i>	Hobby	2007	Broomhill Flash & Wombwell Ings LWS
bird	<i>Falco subbuteo</i>	Hobby	2010	Adwick Washlands
bird	<i>Falco tinnunculus</i>	Kestrel	2007	Broomhill Flash
bird	<i>Falco tinnunculus</i>	Kestrel	2007	Old Moor & Wath Ings LWS
bird	<i>Falco tinnunculus</i>	Kestrel	2009	Old Moor & Wath Ings LWS
bird	<i>Falco tinnunculus</i>	Kestrel	2010	Broomhill Flash
bird	<i>Falco tinnunculus</i>	Kestrel	2011	Old Moor & Wath Ings LWS
bird	<i>Falco tinnunculus</i>	Kestrel	2011	Wath Ings
bird	<i>Falco tinnunculus</i>	Kestrel	2011	Grimethorpe Colliery
bird	<i>Fringilla montifringilla</i>	Brambling	2003	Cudworth Park
bird	<i>Fringilla montifringilla</i>	Brambling	2009	Old Moor & Wath Ings LWS
bird	<i>Fringilla montifringilla</i>	Brambling	2010	Old Moor & Wath Ings LWS
bird	<i>Fringilla montifringilla</i>	Brambling	2010	'BARNSELY MBC'
bird	<i>Fringilla montifringilla</i>	Brambling	2011	Old Moor & Wath Ings LWS
bird	<i>Gallinago gallinago</i>	Snipe	2006	Broomhill Flash
bird	<i>Gallinago gallinago</i>	Snipe	2007	River Dearne Valley wetlands, Dearne/Wombwell
bird	<i>Gallinago gallinago</i>	Snipe	2007	Old Moor & Wath Ings LWS
bird	<i>Gallinago gallinago</i>	Snipe	2007	Broomhill Flash
bird	<i>Gallinago gallinago</i>	Snipe	2007	Wilthorpe Marsh
bird	<i>Gallinago gallinago</i>	Snipe	2009	Old Moor & Wath Ings LWS
bird	<i>Gallinago gallinago</i>	Snipe	2011	Old Moor & Wath Ings LWS
bird	<i>Gallinago gallinago</i>	Snipe	2013	Cudworth Common
bird	<i>Lanius collurio</i>	Red-Backed Shrike	2010	Broomhill Flash
bird	<i>Larus melanocephalus</i>	Mediterranean Gull	2009	Old Moor & Wath Ings LWS

bird	<i>Larus melanocephalus</i>	Mediterranean Gull	2011	Old Moor & Wath Ings LWS
bird	<i>Larus ridibundus</i>	Black-Headed Gull	2006	Broomhill Flash
bird	<i>Larus ridibundus</i>	Black-headed Gull	2007	Old Moor & Wath Ings LWS
bird	<i>Larus ridibundus</i>	Black-Headed Gull	2007	Broomhill Flash
bird	<i>Larus ridibundus</i>	Black-Headed Gull	2009	Old Moor & Wath Ings LWS
bird	<i>Larus ridibundus</i>	Black-Headed Gull	2011	Brampton
bird	<i>Larus ridibundus</i>	Black-Headed Gull	2011	Old Moor & Wath Ings LWS
bird	<i>Larus ridibundus</i>	Black-Headed Gull	2011	Edderthorpe Ings, between Little Houghton & Grimethorpe
bird	<i>Larus ridibundus</i>	Black-Headed Gull	2011	Wath Ings
bird	<i>Larus ridibundus</i>	Black-Headed Gull	2012	Edderthorpe Ings
bird	<i>Larus ridibundus</i>	Black-Headed Gull	2013	Grimethorpe Barnsley
bird	<i>Larus ridibundus</i>	Black-Headed Gull	2013	Cudworth Common
bird	<i>Limosa limosa</i>	Black-tailed Godwit	2007	Old Moor & Wath Ings LWS
bird	<i>Limosa limosa</i>	Black-Tailed Godwit	2007	Edderthorpe Ings
bird	<i>Limosa limosa</i>	Black-Tailed Godwit	2007	Broomhill Flash & Wombwell Ings LWS
bird	<i>Limosa limosa</i>	Black-Tailed Godwit	2009	Old Moor & Wath Ings LWS
bird	<i>Limosa limosa</i>	Black-Tailed Godwit	2010	Adwick Washlands
bird	<i>Limosa limosa</i>	Black-Tailed Godwit	2011	Edderthorpe Ings, between Little Houghton & Grimethorpe
bird	<i>Limosa limosa</i>	Black-Tailed Godwit	2012	Edderthorpe Ings
bird	<i>Numenius phaeopus</i>	Whimbrel	2011	Edderthorpe Ings, between Little Houghton & Grimethorpe
bird	<i>Passer montanus</i>	Tree Sparrow	2005	Broomhill Flash & Wombwell Ings LWS
bird	<i>Passer montanus</i>	Tree Sparrow	2007	Broomhill Flash
bird	<i>Passer montanus</i>	Tree Sparrow	2007	Old Moor & Wath Ings LWS
bird	<i>Passer montanus</i>	Tree Sparrow	2009	Old Moor & Wath Ings LWS
bird	<i>Passer montanus</i>	Tree Sparrow	2010	'BARNSELY MBC'
bird	<i>Passer montanus</i>	Eurasian Tree Sparrow	2010	Old Moor & Wath Ings LWS
bird	<i>Passer montanus</i>	Tree Sparrow	2011	Old Moor & Wath Ings LWS
bird	<i>Perdix perdix</i>	Grey Partridge	2003	River Dove Valley Worsbrough (Worsbrough CP)
bird	<i>Perdix perdix</i>	Grey Partridge	2005	Barrow Colliery Barnsley
bird	<i>Perdix perdix</i>	Grey Partridge	2005	Broomhill Flash & Wombwell Ings LWS
bird	<i>Perdix perdix</i>	Grey Partridge	2007	Old Moor & Wath Ings LWS
bird	<i>Perdix perdix</i>	Grey Partridge	2009	Old Moor & Wath Ings LWS

bird	<i>Perdix perdix</i>	Grey Partridge	2010	Adwick Washlands
bird	<i>Perdix perdix</i>	Grey Partridge	2011	Old Moor & Wath Ings LWS
bird	<i>Perdix perdix</i>	Grey Partridge	2012	Broomhill Flash
bird	<i>Perdix perdix</i>	Grey Partridge	2013	Cudworth Common
bird	<i>Phalacrocorax carbo</i>	Cormorant	2007	Old Moor & Wath Ings LWS
bird	<i>Phalacrocorax carbo</i>	Cormorant	2007	Wilthorpe Marsh
bird	<i>Phalacrocorax carbo</i>	Cormorant	2009	Old Moor & Wath Ings LWS
bird	<i>Phalacrocorax carbo</i>	Cormorant	2009	Edderthorpe Ings
bird	<i>Phalacrocorax carbo</i>	Great Cormorant	2010	Old Moor & Wath Ings LWS
bird	<i>Phalacrocorax carbo</i>	Cormorant	2011	Old Moor & Wath Ings LWS
bird	<i>Phalacrocorax carbo</i>	Cormorant	2011	Edderthorpe Ings, between Little Houghton & Grimethorpe
bird	<i>Phalacrocorax carbo</i>	Cormorant	2012	Edderthorpe Ings
bird	<i>Philomachus pugnax</i>	Ruff	2007	Old Moor & Wath Ings LWS
bird	<i>Philomachus pugnax</i>	Ruff	2009	Old Moor & Wath Ings LWS
bird	<i>Philomachus pugnax</i>	Ruff	2011	Edderthorpe Ings, between Little Houghton & Grimethorpe
bird	<i>Philomachus pugnax</i>	Ruff	2011	Old Moor & Wath Ings LWS
bird	<i>Platalea leucorodia</i>	Spoonbill	2009	Edderthorpe Ings, between Little Houghton & Grimethorpe
bird	<i>Platalea leucorodia</i>	Spoonbill	2009	Old Moor & Wath Ings LWS
bird	<i>Podiceps nigricollis</i>	Black-necked Grebe	2007	Old Moor & Wath Ings LWS
bird	<i>Podiceps nigricollis</i>	Black-Necked Grebe	2011	Old Moor & Wath Ings LWS
bird	<i>Porzana porzana</i>	Spotted Crake	2009	Edderthorpe Ings, between Little Houghton & Grimethorpe
bird	<i>Rallus aquaticus</i>	Water Rail	2007	Wilthorpe Marsh
bird	<i>Rallus aquaticus</i>	Water Rail	2009	Old Moor & Wath Ings LWS
bird	<i>Recurvirostra avosetta</i>	Avocet	2009	Old Moor & Wath Ings LWS
bird	<i>Recurvirostra avosetta</i>	Avocet	2011	Edderthorpe Ings
bird	<i>Recurvirostra avosetta</i>	Avocet	2011	Old Moor & Wath Ings LWS
bird	<i>Recurvirostra avosetta</i>	Avocet	2011	Edderthorpe Ings, between Little Houghton & Grimethorpe
bird	<i>Regulus ignicapilla</i>	Firecrest	2007	River Dearne Valley wetlands, Dearne/Wombwell
bird	<i>Tringa glareola</i>	Wood Sandpiper	2011	Edderthorpe Ings
bird	<i>Tringa glareola</i>	Wood Sandpiper	2011	Edderthorpe Ings, between Little Houghton & Grimethorpe
bird	<i>Tringa glareola</i>	Wood Sandpiper	2011	Old Moor & Wath Ings LWS
bird	<i>Tringa nebularia</i>	Greenshank	2007	Old Moor & Wath Ings LWS

bird	<i>Tringa nebularia</i>	Greenshank	2009	Old Moor & Wath Ings LWS
bird	<i>Tringa nebularia</i>	Greenshank	2011	Edderthorpe Ings, between Little Houghton & Grimethorpe
bird	<i>Tringa nebularia</i>	Greenshank	2011	Edderthorpe Ings
bird	<i>Tringa nebularia</i>	Greenshank	2011	Old Moor & Wath Ings LWS
bird	<i>Tringa ochropus</i>	Green Sandpiper	2007	River Dearne Valley wetlands, Dearne/Wombwell
bird	<i>Tringa ochropus</i>	Green Sandpiper	2007	Old Moor & Wath Ings LWS
bird	<i>Tringa ochropus</i>	Green Sandpiper	2007	Grimethorpe Ings
bird	<i>Tringa ochropus</i>	Green Sandpiper	2007	Wilthorpe Marsh
bird	<i>Tringa ochropus</i>	Green Sandpiper	2009	Old Moor & Wath Ings LWS
bird	<i>Tringa ochropus</i>	Green Sandpiper	2010	Little Houghton Ings
bird	<i>Tringa ochropus</i>	Green Sandpiper	2011	Old Moor & Wath Ings LWS
bird	<i>Tringa ochropus</i>	Green Sandpiper	2011	Edderthorpe Ings, between Little Houghton & Grimethorpe
bird	<i>Tringa totanus</i>	Common Redshank	2004	Edderthorpe Ings
bird	<i>Tringa totanus</i>	Redshank	2006	Broomhill Flash
bird	<i>Tringa totanus</i>	Common Redshank	2007	River Dearne Valley wetlands, Dearne/Wombwell
bird	<i>Tringa totanus</i>	Common Redshank	2007	Old Moor & Wath Ings LWS
bird	<i>Tringa totanus</i>	Redshank	2007	Broomhill Flash
bird	<i>Tringa totanus</i>	Common Redshank	2007	Wilthorpe Marsh
bird	<i>Tringa totanus</i>	Redshank	2007	Broomhill Flash & Wombwell Ings LWS
bird	<i>Tringa totanus</i>	Redshank	2007	Edderthorpe Ings
bird	<i>Tringa totanus</i>	Redshank	2009	Old Moor & Wath Ings LWS
bird	<i>Tringa totanus</i>	Redshank	2009	Cudworth Common
bird	<i>Tringa totanus</i>	Redshank	2009	Edderthorpe Ings
bird	<i>Tringa totanus</i>	Redshank	2010	Little Houghton Ings
bird	<i>Tringa totanus</i>	Common Redshank	2010	Old Moor & Wath Ings LWS
bird	<i>Tringa totanus</i>	Redshank	2011	Old Moor & Wath Ings LWS
bird	<i>Tringa totanus</i>	Redshank	2011	Edderthorpe Ings, between Little Houghton & Grimethorpe
bird	<i>Turdus iliacus</i>	Redwing	2003	River Dove Valley Worsbrough (Worsbrough CP)
bird	<i>Turdus iliacus</i>	Redwing	2007	Old Moor & Wath Ings LWS
bird	<i>Turdus iliacus</i>	Redwing	2009	Old Moor & Wath Ings LWS
bird	<i>Turdus iliacus</i>	Redwing	2011	Old Moor & Wath Ings LWS
bird	<i>Turdus pilaris</i>	Fieldfare	2003	River Dove Valley Worsbrough (Worsbrough CP)

bird	<i>Turdus pilaris</i>	Fieldfare	2007	Old Moor & Wath Ings LWS
bird	<i>Turdus pilaris</i>	Fieldfare	2009	Old Moor & Wath Ings LWS
bird	<i>Turdus pilaris</i>	Fieldfare	2010	'BARNSELEY MBC'
bird	<i>Turdus pilaris</i>	Fieldfare	2013	Cudworth
bird	<i>Tyto alba</i>	Barn Owl	2005	Broomhill Flash & Wombwell Ings LWS
bird	<i>Tyto alba</i>	Barn Owl	2007	Broomhill Flash
bird	<i>Tyto alba</i>	Barn Owl	2009	Old Moor & Wath Ings LWS
bird	<i>Tyto alba</i>	Barn Owl	2010	Broomhill Flash
bird	<i>Tyto alba</i>	Barn Owl	2010	'BARNSELEY MBC'
bird	<i>Vanellus vanellus</i>	Northern Lapwing	2004	Edderthorpe Ings
bird	<i>Vanellus vanellus</i>	Lapwing	2005	Broomhill Flash & Wombwell Ings LWS
bird	<i>Vanellus vanellus</i>	Lapwing	2006	Broomhill Flash
bird	<i>Vanellus vanellus</i>	Lapwing	2007	Broomhill Flash
bird	<i>Vanellus vanellus</i>	Lapwing	2007	Old Moor & Wath Ings LWS
bird	<i>Vanellus vanellus</i>	Northern Lapwing	2007	Wiltorpe Marsh
bird	<i>Vanellus vanellus</i>	Lapwing	2009	Cudworth Common
bird	<i>Vanellus vanellus</i>	Lapwing	2009	Old Moor & Wath Ings LWS
bird	<i>Vanellus vanellus</i>	Lapwing	2010	Little Houghton Ings
bird	<i>Vanellus vanellus</i>	Lapwing	2010	Adwick Washlands
bird	<i>Vanellus vanellus</i>	Northern Lapwing	2010	Old Moor & Wath Ings LWS
bird	<i>Vanellus vanellus</i>	Lapwing	2011	Old Moor & Wath Ings LWS
bird	<i>Vanellus vanellus</i>	Lapwing	2011	Edderthorpe Ings, between Little Houghton & Grimethorpe
bird	<i>Vanellus vanellus</i>	Lapwing	2011	Edderthorpe Ings
bird	<i>Vanellus vanellus</i>	Lapwing	2012	Edderthorpe Ings
bird	<i>Vanellus vanellus</i>	Lapwing	2013	Cudworth
bird	<i>Vanellus vanellus</i>	Lapwing	2013	Cudworth Common
bird	<i>Vanellus vanellus</i>	Lapwing	2013	Grimethorpe Barnsley
reptile	<i>Lacerta vivipara</i>	Viviparous Lizard	2012	Edderthorpe Ings
terrestrial mammal	<i>Arvicola amphibius</i>	Water Vole	2012	'BARNSELEY MBC'
terrestrial mammal	<i>Pipistrellus pipistrellus 45kHz</i>	45 Khz Pipistrelle	2004	'BARNSELEY MBC'
terrestrial mammal	<i>Pipistrellus pipistrellus 45kHz</i>	45 Khz Pipistrelle	2004	Grimethorpe Barnsley