

## Summary Sheet

<b>Date</b>	14/05/13
<b>Grid Reference</b>	SE 260 028
<b>Site Area</b>	1.28 ha
<b>Surveyor</b>	Chris Doar, Wildscapes

<b>Site Name</b>	Land north of Sheffield Road
<b>Site Ref Number</b>	P2

### 1 ASSESSMENT

Biodiversity interest (record presence by a cross as appropriate)

Habitat	Present	Notes & photo refs
Woodland		
Scrub	X	
Scattered trees	X	Mature Oak and Beech
Species poor or defunct hedgerows		
Species rich hedgerows		
Amenity or improved grassland		
Semi-improved grassland	X	Species-poor; P2.1; P2.2
Unimproved grassland		
Marshy grassland		
Tall ruderals	X	
Dwarf shrub heath		
Lichen/bryophyte heath		
Reedbed		
Swamp		
Standing water (ponds)		
Flowing watercourses		
Arable / cultivated farmland		
Other:		

Species	Present (seen)	Quality of habitat		
		Low	Mod	High
Plants	X	X		
Invertebrates	X		X	
Amphibians		X		
Reptiles		X		
Birds	X	X		
Mammals			X	
Other				

### Influences on external features

On watercourse	No
On wildlife corridor	Directly adjacent to the wooded corridor of the River Don.
Would lead to habitat isolation	No
Proximity/linkage to SSSI/LNR	None
Other	The River Don is within 100m. It flows through woodland directly adjacent to P2. The woodland on the opposite bank of the river has been classified as ancient woodland.

## 2 RECOMMENDATION

	Mitigation measures / design considerations	Score
a) Development of the site would have minimal detrimental local ecological impact.	The three mature trees present on the site's north-eastern boundary should be retained within the scope of any development. See Figure 2. A buffer strip along this entire edge would prevent the site from being developed right up to the woodland edge.	1
b) Development of the site would result in some adverse local ecological impact but there is scope for mitigation.		
c) Development of the site for housing would result in detrimental ecological impacts.		

## 3 PHOTOGRAPHIC DETAILS

Photograph locations are recorded on the site map.

Photo Ref	Caption
P2.1	View over eastern field.
P2.2	View over western field.

## 4 FURTHER INFORMATION

### Brief Site Description

The site comprises a couple of fields lying north of the B6462 immediately east of Penistone. It is vegetated by semi-improved, species-poor grassland.  
Of note are three mature Oak and Beech trees along the north-eastern boundary.

### Additional comments / information

With reference to the data search, no significant issues for protected or priority species have arisen for this site.

Figure 1 shows the Phase 1 Habitat map for the site.  
Figure 2 shows the areas with significant ecological value.

Penistone Area

Sub-site P2

Site Area: 1.28 ha

OS Grid Ref: SK 260 028

Date Surveyed: 14/05/13

Surveyor: Chris Doar

### Site Description

The site comprises a couple of fields lying north of the B6462 immediately east of Penistone. The site is bounded by woodland along its north-eastern edge, a road (the B6462) to the south, and an industrial complex to the west. A pylon line runs across the site, with one pylon in the larger of the two fields.

The site is vegetated by semi-improved, neutral grassland. This grassland is species-poor, being dominated by False Oat-grass (*Arrhenatherum elatius*), with Meadow Foxtail (*Alopecurus pratensis*) and Cock's-foot (*Dactylis glomerata*) also forming a significant component of the sward. Cow Parsley (*Anthriscus sylvestris*) is the only forb present in any quantity in the sward.

Small areas of Raspberry (*Rubus ideaus*) scrub are present along the site's north eastern boundary. Also of note are three mature trees – Oak (*Quercus x rosacaea*) and Beech (*Fagus sylvatica*) also along this boundary.



Photo P2.1 View over eastern field.



Photo P2 .2 View over western field.

## Species List for P2

### DAFOR Scale

D=dominant, A=abundant, F=frequent, O=occasional, R=rare, L=locally

### **Grassland**

#### **Trees and Shrubs**

Beech	<i>Fagus sylvatica</i>	R
Oak	<i>Quercus ×rosacea</i>	R
Bramble	<i>Rubus fruticosus</i> agg.	O
Raspberry	<i>Rubus idaeus</i>	LD
Elder	<i>Sambucus nigra</i>	R

#### **Herbs**

Cow Parsley	<i>Anthriscus sylvestris</i>	A
Common Mouse-ear	<i>Cerastium fontanum</i>	R
Rosebay Willowherb	<i>Chamerion angustifolium</i>	LD
Creeping Thistle	<i>Cirsium arvense</i>	O
Cleavers	<i>Galium aparine</i>	LF
Hogweed	<i>Heracleum sphondylium</i>	R
Bluebell	<i>Hyacinthoides non-scripta</i>	R
Ribwort Plantain	<i>Plantago lanceolata</i>	R
Broad-leaved Dock	<i>Rumex obtusifolius</i>	O
Common Ragwort	<i>Senecio jacobaea</i>	O
Common Chickweed	<i>Stellaria media</i>	O
Red Clover	<i>Trifolium pratense</i>	R

#### **Grasses, sedges and rushes**

Meadow Foxtail	<i>Alopecurus pratensis</i>	F
False Oat-grass	<i>Arrhenatherum elatius</i>	D
Cock's-foot	<i>Dactylis glomerata</i>	F
Red Fescue	<i>Festuca rubra</i>	O

**Figure 1. Phase 1 Habitat Map: May 2013**

**Site P2**

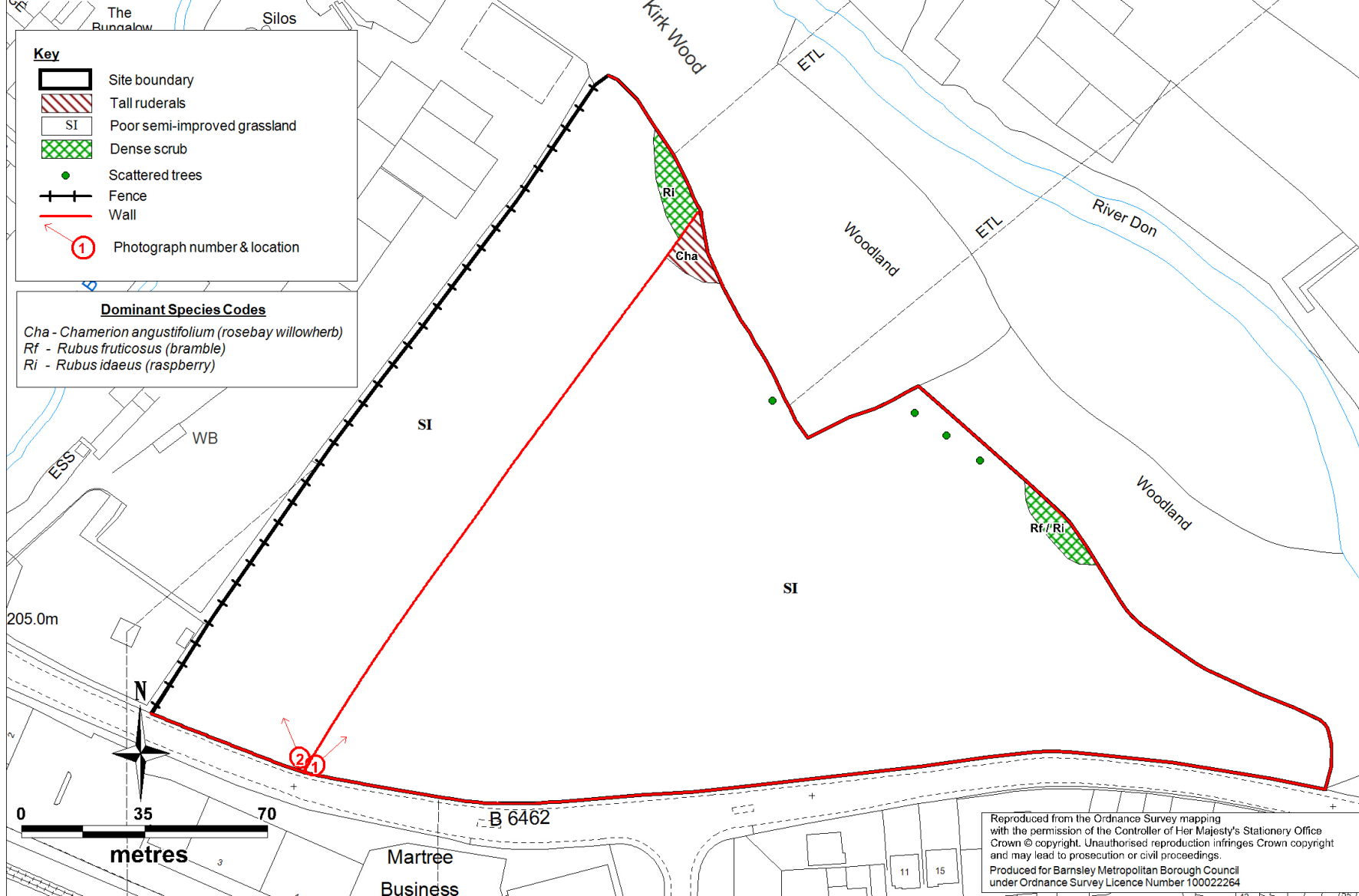



**Figure 2. Ecological Value: Site P2**

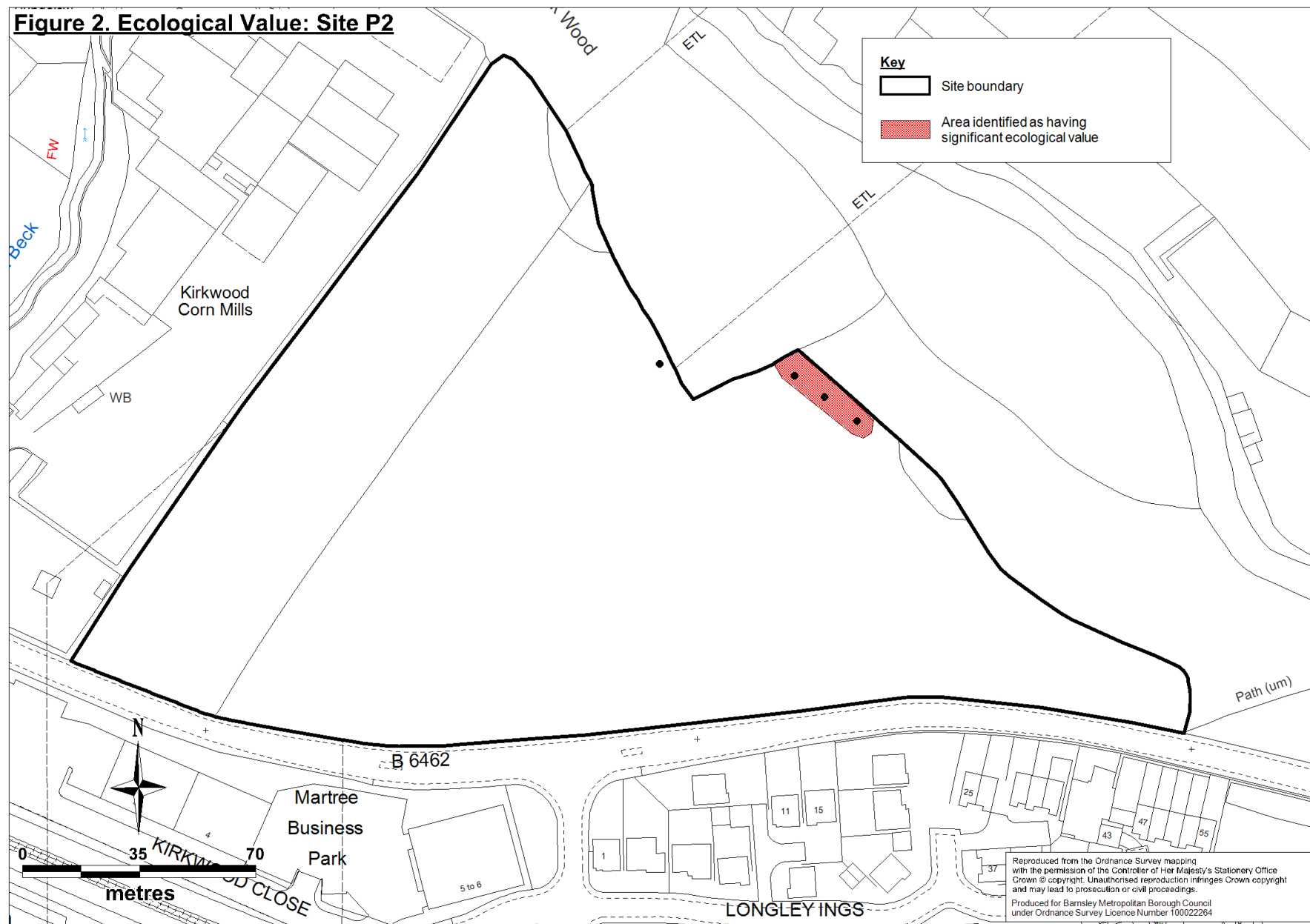

**Data Search – Local Records Centre**

Notable species recorded within 1km of the site in the last 10 years (2003 – 2013)

A search for badger records has been carried out separately.

<b>Group</b>	<b>Scientific Name</b>	<b>Common Name</b>	<b>Year</b>	<b>Location</b>
bird	<i>Falco peregrinus</i>	Peregrine	2011	Cubley
bird	<i>Falco subbuteo</i>	Hobby	2012	'BARNSELY MBC'
bird	<i>Falco tinnunculus</i>	Kestrel	2003	Penistone Town
bird	<i>Falco tinnunculus</i>	Kestrel	2011	Oxspring
bird	<i>Falco tinnunculus</i>	Kestrel	2012	Oxspring
bird	<i>Larus ridibundus</i>	Black-Headed Gull	2011	Ingbirchworth Reservoir LWS
bird	<i>Larus ridibundus</i>	Black-Headed Gull	2011	Ingbirchworth Reservoir
bird	<i>Larus ridibundus</i>	Black-Headed Gull	2013	Penistone
bird	<i>Passer montanus</i>	Tree Sparrow	2010	Oxspring
bird	<i>Passer montanus</i>	Tree Sparrow	2013	Penistone
bird	<i>Perdix perdix</i>	Grey Partridge	2010	'BARNSELY MBC'
bird	<i>Turdus pilaris</i>	Fieldfare	2010	'BARNSELY MBC'
bird	<i>Turdus pilaris</i>	Fieldfare	2010	Cubley
bird	<i>Vanellus vanellus</i>	Lapwing	2007	Oxspring village, Don Valley Thurgoland bridge to Oxspring
bird	<i>Vanellus vanellus</i>	Lapwing	2013	Roughbirchworth Common
terrestrial mammal	<i>Chiroptera</i>	Bats	2004	Oxspring
terrestrial mammal	<i>Chiroptera</i>	Bats	2008	Hackings Avenue Penistone, Barnsley MDC
terrestrial mammal	<i>Erinaceus europaeus</i>	Hedgehog	2012	Oxspring
terrestrial mammal	<i>Pipistrellus pipistrellus</i>	Pipistrelle	2008	Tennyson Close Penistone, Barnsley MDC