

Special Signage

Hospital
Town Centre

Town Centre | M1
School | A6133

1200x1200x 4 1200x1200x 4

Temporary bus stop

Bus stop suspended

BUS STOPS TO BE SUSPENDED AND MOVED AS REQUIRED.

Traffic Light Timing Matrix

Phase	T.Flow	Max Green	All Red	Location
1	→	30	10	ROAD
2	←	30	10	ROAD

Phase	T.Flow	Green	All Red	Black Out	Location
3	↕	7	3	3	Ped Crossing

- NOTES**
- All traffic signs shall comply with Chapter 8 of the Traffic Signs Manual
 - Maximum distance between any two temporary traffic signals to be 249m. Minimum distance between any two temporary traffic signals to be 30m.
 - Temporary traffic signals shall not occur within 150m of an existing level crossing. Pelican crossing or signalised junction without the consent of the Engineer. The Engineer shall consult with the authority responsible for any of these types of facility prior to traffic management being installed in adjacent areas.
 - Coning shall be installed at 45° to the edge of carriageway, as generally indicated.

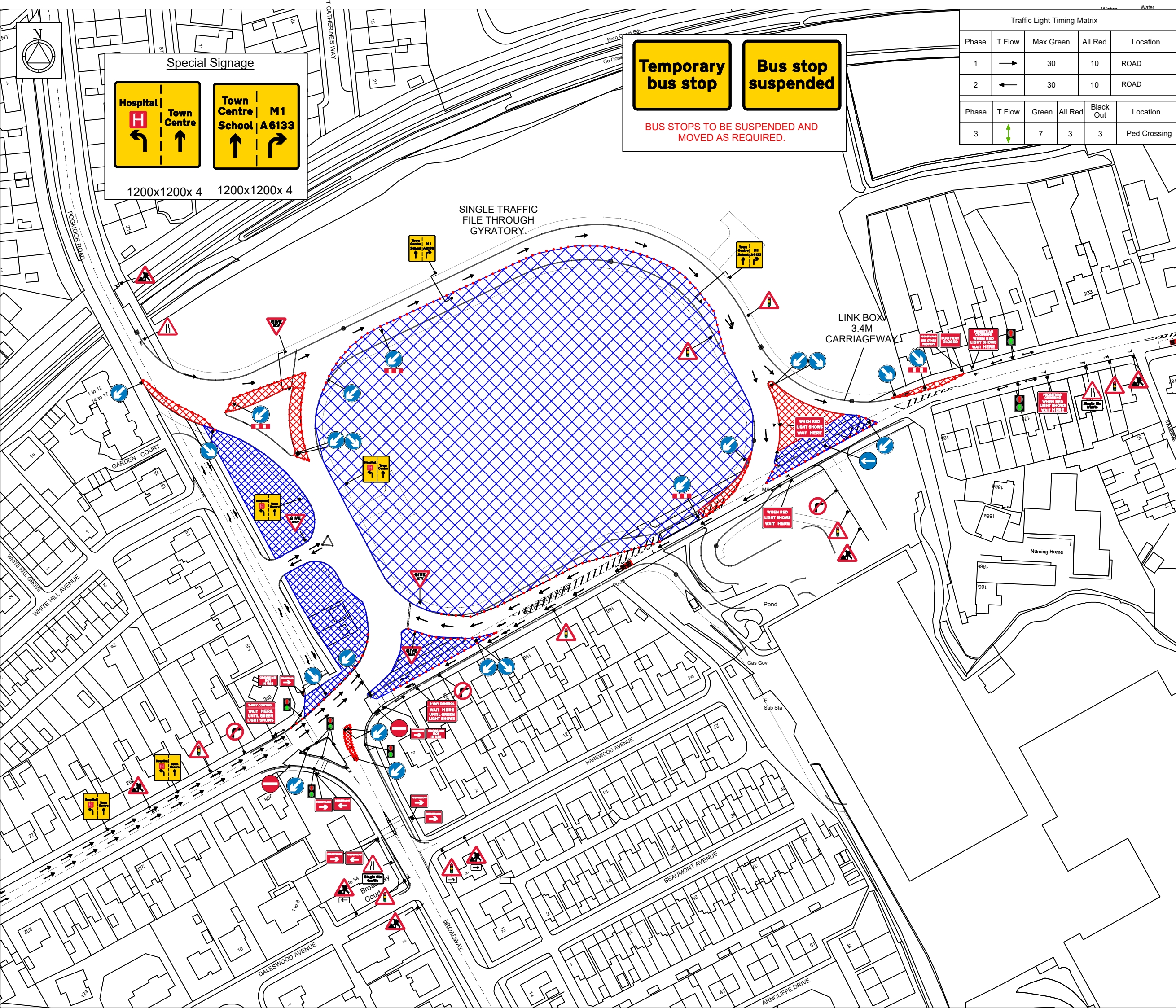

KEY

- Traffic Signal
- Datum
- Sign
- Traffic Cone
- Works Area
- Safety Zone

Rev	Description	By	Chkd	Date
5	REV 5 as per clients request	GB	PB	25/11/21
4	REV 4 as per clients request	GB	PB	14/11/21
3	REV 3 as per clients request	GB	PB	08/11/21
2	REV 2 as per clients request	GB	PB	19/08/21
1	REV 1 as per clients request	GB	PB	24/06/21

Client

Revisions

PHASE 4 REV 5

Project

A628 DODWORTH ROAD/
A6133 BROADWAY,
BARNSELY S70 6QE

Title

MULTIPLE SETUPS

Design: UPD	Drawn: GB	Chkd: PB
Date: 16/06/2021	Date: 16/06/2021	Date: 16/06/2021
Scale: NTS @ A3	Status: FOR-ISSUE	
Drawing No: UDP-9330		Rev: 1