

Horizon College Traffic and Pedestrian Management Details:-

From the 17th February 2022, the following plans will come into force until further notice:-

- Horizon College Traffic and Pedestrian Management Plans
- A628 Dodworth Road Pedestrian Movement Plan
- Phase 4 Rev 5 Multiple Setup

Pedestrian Routes:-

All safe pedestrian routes are clearly marked on the above-named drawings and highlighted in blue. All other areas not marked will be out of bounds to members of the public. All working areas will be securely fenced off using Heras type fencing with adequate signage navigating pedestrians.

Please use all existing/temporary crossing points at all times.

Vehicle access to Horizon College:-

Vehicles wishing to access Horizon College can now avoid the current diversion and access the College using the new entrance. New signage will be in place. Please follow the current one-way routes within the College Car Park and use the new exit.

Vehicles travelling from Barnsley Town Centre can access the College without following any diversion and access into the new entrance.

There will be a **NO RIGHT TURN** when exiting the College. **ALL** vehicles must turn left and follow the diversion signage or on to the gyratory. The **EXIT** will be a **GIVE WAY**, so please proceed with caution.

Please see additional information and should you wish for any further information please visit Barnsley Metropolitan Borough Council website. The QR code below can direct you to the relevant section.

Regards, Customer Liaison Team - 0800 032 8707

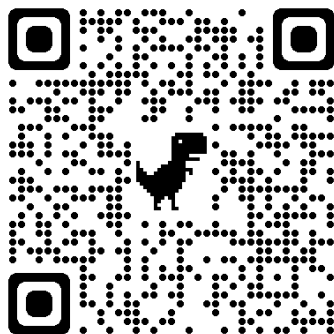

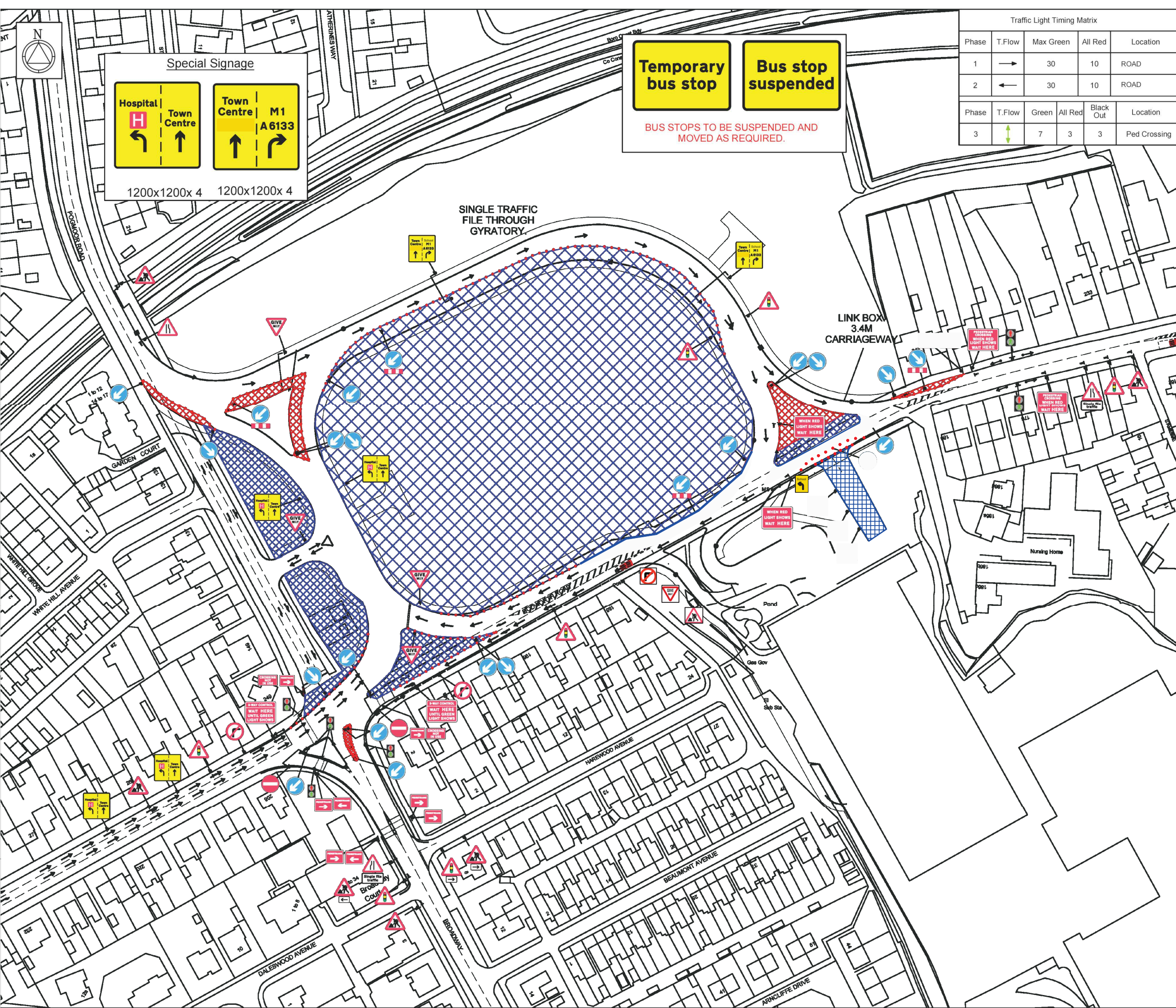

Traffic Light Timing Matrix					
Phase	T.Flow	Max Green	All Red	Location	
1	→	30	10	ROAD	
2	←	30	10	ROAD	
Phase	T.Flow	Green	All Red	Black Out	Location
3	↕	7	3	3	Ped Crossing

- NOTES
- 1 All traffic signs shall comply with Chapter 8 of the Traffic Signs Manual
 - 2 Maximum distance between any two temporary traffic signs to be 240m. Minimum distance between any two temporary traffic signs to be 30m.
 - 3 Temporary traffic signs shall not occur within 150m of an existing level crossing. Pedestrian crossing or signalised junction without the consent of the Engineer. The Engineer shall consult with the authority responsible for any of these types of facility prior to traffic management being installed in adjacent areas.
 - 4 Coning shall be installed at 45° to the edge of carriageway, as generally indicated.

KEY	
Traffic Signal	
Datum	
Sign	
Traffic Cone	
Works Area	
Safety Zone	

5	REV 5 as per clients request	GB	PB	25/11/21
4	REV 4 as per clients request	GB	PB	14/11/21
3	REV 3 as per clients request	GB	PB	08/11/21
2	REV 2 as per clients request	GB	PB	19/08/21
1	REV 1 as per clients request	GB	PB	24/06/21

Rev	Description	By	Chkd	Date
-----	-------------	----	------	------

Client

Revisions



casey
PRO ENVIRONMENT

PHASE 4 REV 5

Project

A628 DODWORTH ROAD/
A6133 BROADWAY,
BARNSELY S70 6QE

Title

MULTIPLE SETUPS



utilities design & planning Ltd.

Design: UPD	Drawn: GB	Chkd: PB
Date: 16/06/2021	Date: 16/06/2021	Date: 16/06/2021
Scale: NTS @ A3	Status: FOR-ISSUE	
Drawing No UDP-8330		Rev: 1

